

# TEMPORARY CONSTRUCTION EASEMENT

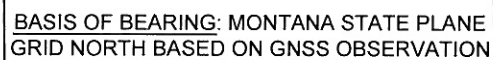

FEBRUARY, 2021



SCALE IN FEET  
(PLOT SIZE = 8.5" x  
11")

LOCATED IN THE S 1/2, SECTION 12,  
T. 13 N., R. 20 W., P.M.  
MISSOULA COUNTY, MONTANA

DJ  
& G

ENGINEERS  
PLANNERS  
SURVEYORS

# EXHIBIT "D"

## TEMPORARY CONSTRUCTION EASEMENT

### LEGAL DESCRIPTION:

A 10 FOOT WIDE TEMPORARY CONSTRUCTION EASEMENT, OVER AND ACROSS PORTIONS OF TRACT 8A, CERTIFICATE OF SURVEY 6109, AS RECORDED IN MISSOULA COUNTY, MT. RECORDS, LOCATED IN THE SOUTH HALF OF SECTION 12, TOWNSHIP 13 NORTH., RANGE 19 WEST, P. M., M. AND MORE PARTICULARLY DESCRIBED AS A STRIP OF LAND 10 FEET WIDE LYING NORTHWEST AND ADJACENT TO THE PERMANENT RIGHT OF WAY EASEMENT PREVIOUSLY DEDICATED TO THE PUBLIC AS GEORGE ELMER DRIVE AND PARALLEL TO THE CENTERLINE OF SAID GEORGE ELMER DRIVE.

THE SIDELINES OF THIS EASEMENT LENGTHEN OR SHORTEN TO INTERSECT THE SOUTH BOUNDARY OF TRACT 8A, CERTIFICATE OF SURVEY 6109 ON THE SOUTH AND THE SOUTH BOUNDARY OF TRACT 8A, CERTIFICATE OF SURVEY 6109, ON THE NORTH.

TOGETHER WITH A STRIP OF LAND 10 FEET WIDE LYING SOUTHEAST AND ADJACENT TO THE PERMANENT RIGHT OF WAY EASEMENT PREVIOUSLY DEDICATED TO THE PUBLIC AS GEORGE ELMER DRIVE AND PARALLEL TO THE CENTERLINE OF SAID GEORGE ELMER DRIVE.

THE SIDELINES OF THIS EASEMENT LENGTHEN OR SHORTEN TO INTERSECT THE SOUTH BOUNDARY OF TRACT 8A, CERTIFICATE OF SURVEY 6109 ON THE SOUTH AND THE SOUTH BOUNDARY OF TRACT 8A, CERTIFICATE OF SURVEY 6109, ON THE NORTH.

CONTAINING 0.31 ACRES OF LAND, MORE OR LESS.

I HEREBY STATE THAT THIS EASEMENT EXHIBIT HAS BEEN PREPARED BY ME OR UNDER MY DIRECT SUPERVISION DURING THE MONTH OF FEBRUARY, 2021.

SIGNED

  
DONALD M. ROEDEL, P.L.S. 10999LS

DATE

2/22/2021

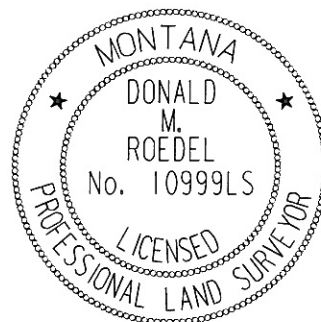

ENGINEERS  
PLANNERS  
SURVEYORS

FEBRUARY, 2021