

Jef 6/11/21
08 @ 0051

EXA	MISSOULA		MONTANA		WOITH ENGINEERING, INC. ENGINEERS & SURVEYORS <small>403 3RD STREET NW, SUITE 204 • GREAT FALLS, MT 59404 • 406-763-1955 3800 O'LEARY STREET, SUITE 4 • MISSOULA, MT 59801 • 406-233-6555 • WWW.WOITHENG.COM •</small>	DESCRIPTION	DATE	JOB # 2101 DRAWN TRH DESIGN TRH GAI KTB DATE 6/2/2021
	RIVERFRONT TRAILS							
	PROPOSED HYDRANT LAYOUT EXHIBIT							

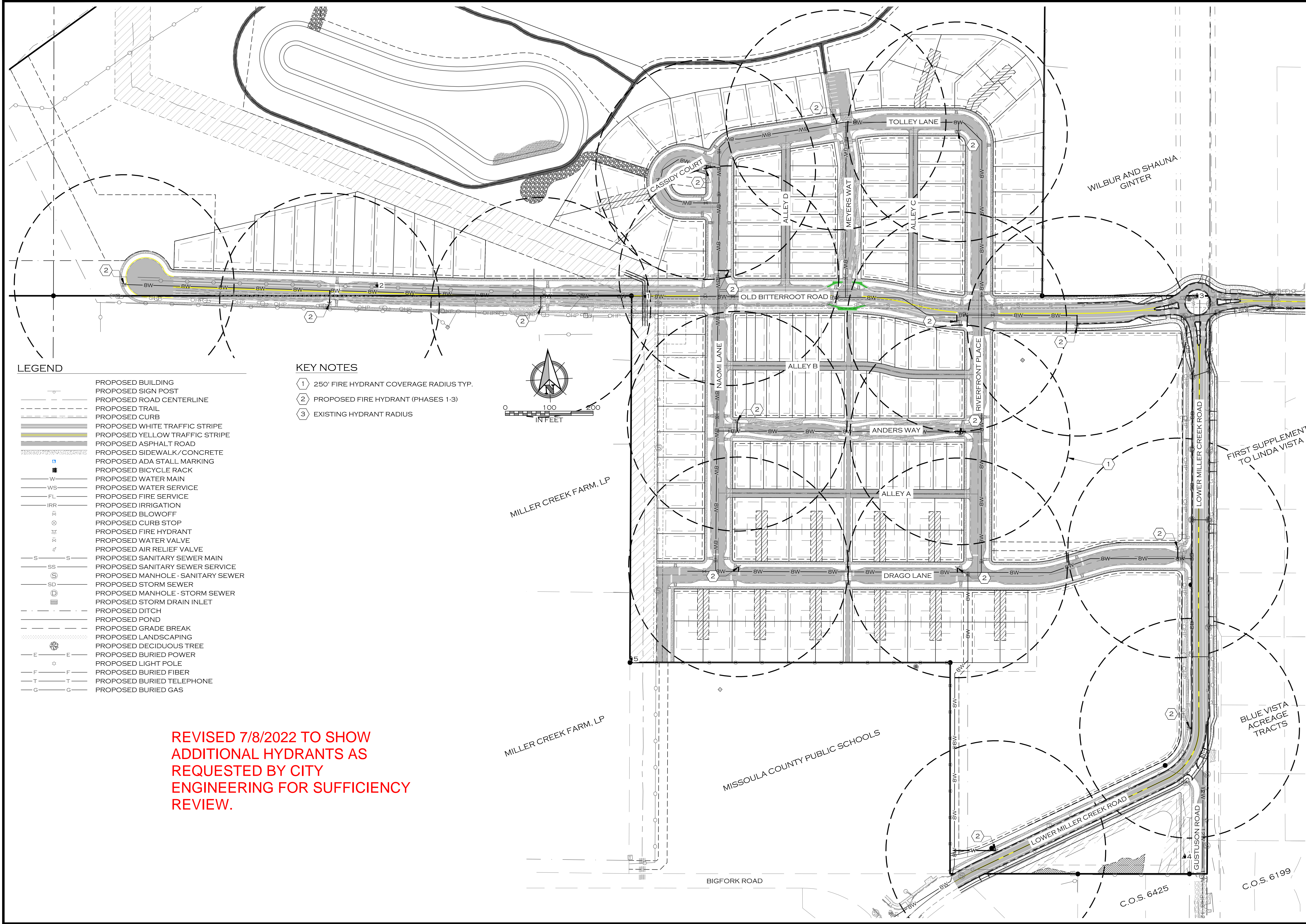

2101	
JOB #:	TRH
DRAWN:	TRH
DESIGN:	KTS
QA:	
DATE:	7/8/2022
DATE	
DESCRIPTION	
#	
WOITH ENGINEERING, INC.	
ENGINEERS & SURVEYORS	
405 3RD STREET NW, SUITE 206 • GREAT FALLS, MT 59404 • 406-751-1955	
3000 CLARY STREET, SUITE 100 • MISSOULA, MT 59801 • 406-233-5505	
WWW.WOITHENG.COM • COPYRIGHT © WOITH ENGINEERING, INC. 2021	
MONTANA	
RIVERFRONT TRAILS	
MISSOULA	
PROPOSED HYDRANT LAYOUT EXHIBIT	
EX-A	



May 25, 2021

City of Missoula Fire Department
Dax Fraser, Fire Marshal
435 Ryman Street
Missoula, Mt 59802

Via Email: dfraser@ci.missoula.mt.us

RE: Riverfront Trails Proposed Subdivision Fire Hydrant Layout

Dax,

Tollefson Properties, LLC is proposing to subdivide approximately 92.73 acres of land into approximately 168 lots containing single-family residential homes, townhomes, and courtyard townhomes, a 5.47-acre lot intended for multifamily development, and a 5.13-acre lot intended for a senior living facility. The parcel to be subdivided can be more particularly described as Parcel Tract 1 of Certificate of Survey 6449 located in Section 2, Township 12 North, Range 20 West. The Subject parcel is located to the north and south of Old Bitterroot Road and to the west of Lower Miller Creek Road. The subdivision property lies adjacent to the Bitterroot River to the north and the Jeanette Rankin School, Linda Vista Subdivision, and Blue Vista Acreage Tracts to the south. All proposed water mains will be extensions of the existing City of Missoula Distribution System mains through an offsite connection to an existing 12" main in Gustuson Road, and an existing 8" main located in Bigfork Road. All water main extensions shall meet the Montana Public Works Standard Specifications and Missoula City Public Works Standards and Specifications Manual. Phase 1-3 is expected to commence construction in 2021 and be completed by 2024.

Please review the attached Site Plan and Proposed Fire Hydrant Layout included for phases 1-3. The City of Missoula is requesting your approval on the project layout, fire protection infrastructure location as it pertains to the Missoula Fire Department. It is also requested that you provide a flow rate in gallons per minute that you would like to see achieved by the proposed fire hydrants. Please let us know if any further information is needed for your review. Otherwise, please sign this approval letter below and mail or email it back with a desired Hydrant Flow Rate. We will need this approval to provide to DEQ and the City of Missoula in their review of the proposed Subdivision. If you prefer to include a separate letterhead feel free to do so.

If you have any questions or require anything further for your review, please contact me.

Sincerely,
Woith Engineering, Inc.

Anthony Hilliard

Enclosed: Site Plan Showing Proposed Hydrant Layout for Phases 1-3.

The City of Missoula Fire Department has reviewed the proposed plans and proposed fire hydrant locations, for the Riverfront Trails Subdivision. The Department approves the proposed site plan and has no further recommendations for this development.

Signature

Print

Date